

OPTIMAL WARMING

Prewarm

- 1 a** Press the Power switch to the On position.
b Press the Prewarm button to preset the power level to 25%.

Using Baby Mode

- 2** Gently clean and dry the baby's skin where you intend to place the skin sensor.
- 3 a** Remove the plastic backing from the reflective sensor cover.
b Place the colored side of the skin sensor in the center of the sensor cover.
c Plug the skin sensor into the panel socket. Gently place onto the baby in the desired location.

Supine - midway between xiphoid and umbilicus

Prone - soft tissue area either side of lower spine

Lateral - on side but clear of baby's arms

WARNING: *Ensure the skin sensor is always placed directly beneath the heater.*

- 4** Press the Baby Mode button.
- 5** Set the desired temperature between 34.5°C and 37.5°C using the Control knob. The baby's skin temperature is displayed above the Set Temperature.
- 6** The warmer will automatically adjust the heater power to stabilize the baby's skin temperature to the desired temperature.

WARNING: *Independent temperature monitoring is essential for any baby under an infant radiant warmer.*

Other Features

Manual Mode

- Press the Manual Mode button.
- Set the desired heater power level between 0% and 100% using the Control knob.

SENSOR PLACEMENT FOR MEASURING THE BABY'S SKIN TEMPERATURE

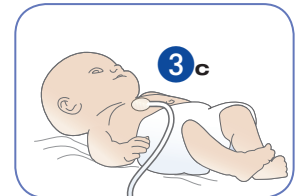
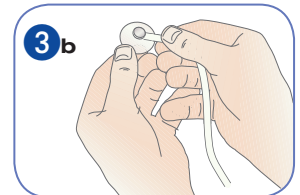

MANUAL WARMING

Prewarm

- 1 a** Press the Power switch to the On position.
b Press the Prewarm button to preset the power level to 25%.

Using Baby Mode

- 2** Press the Manual Mode button.
- 3** Set the desired heater power level between 0% and 100% using the Control knob.

To monitor the baby's temperature in Manual Mode

- 4 a** Remove the plastic backing from the reflective sensor cover.
b Place the colored side of the skin sensor in the center of the sensor cover.
c Plug the skin sensor into the panel socket. Gently place onto the baby in the desired location.

- Supine** - midway between xiphoid and umbilicus
- Prone** - soft tissue area either side of lower spine
- Lateral** - on side but clear of baby's arms

WARNING: Ensure the skin sensor is always placed directly beneath the heater.

The baby's skin temperature is displayed above the control knob.

Independent temperature monitoring is essential for any baby under an infant radiant warmer.

We recommend continuous monitoring of the baby's clinical condition and skin temperature using the skin sensor together with an independent temperature monitor when using Manual Mode.

SENSOR PLACEMENT FOR MEASURING THE BABY'S SKIN TEMPERATURE

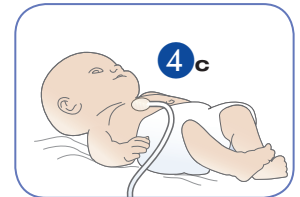
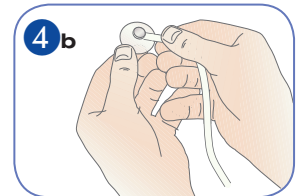

This Set Up Guide applies to all Fisher & Paykel CosyCot™, Mobile and Wall Mount Infant Warmers.

FUNCTION BUTTONS

BABY MODE



On /Off

Apgar:

Press to start, tones will sound at 1, 5 and 10 minute intervals. The timer counts up to 60 minutes.

Light:

Press On or Off.

Mute:

Press to silence audible alarm for 10 minutes.

Procedure Timers:

Two independant timers start from 1 to 99 minutes. Press to activate. To alter time period, hold timer button down and rotate the Control knob to the desired time, then release. Timer will begin counting down.

Control Knob:

Adjusts set temperature in Baby Mode and power bar setting in Manual Mode.

Power Bar:

Indicates power output from the warmer heater. Useful in determining the thermoregulatory requirements of the baby.

Skin Sensor Socket:

Insert skin sensor to measure baby's skin temperature.

MANUAL MODE

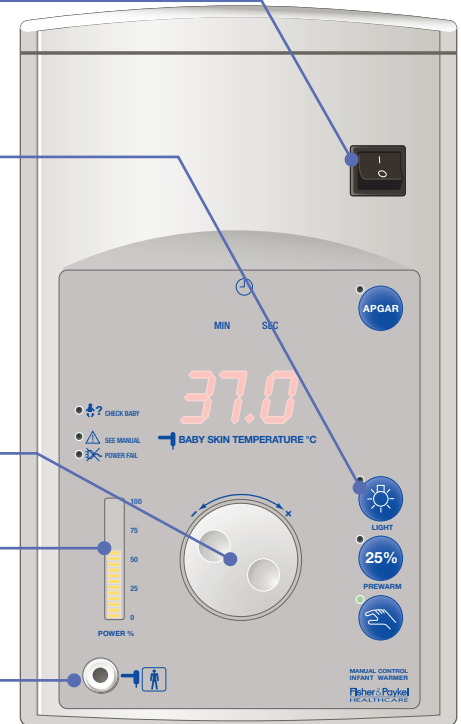

TROUBLE SHOOTING GUIDE

Indicators



Check Baby Alarm

Cause: The Infant Warmer has been in Manual Mode above 25% power or Baby Mode at 100% power for more than 15 minutes. The power level automatically reduces to 25% power until the Mute button is pressed.

Action: Check skin sensor placement and press the Mute button to silence alarm. Check baby's clinical condition.

+1°C High Skin Temp Alarm

Cause: The baby's skin temperature is 1°C higher than the set temperature. The heater will disable. The set temperature may have been adjusted by greater than 1°C. The baby may be experiencing heat stress due to fever.

Action: Press the Mute button to silence the audible alarm for 10 minutes. The heater will be deactivated and will reactivate as the baby's temperature stabilizes to within 1°C of the set temperature. Reassess the baby's clinical condition

-1°C Low Skin Temp Alarm

Cause: The baby's skin temperature is 1°C lower than the set temperature. The heater power is reduced to 25%. The set temperature may have been adjusted by more than 1°C.

The skin sensor may be positioned incorrectly or the baby may be experiencing cold stress.

Action: Press the Mute button, this will silence the audible alarm for 10 minutes and the heater will be reactivated. Check the position of the skin sensor and that the baby has not been covered. Assess the baby's clinical condition.



Sensor Disconnect

Cause: The skin sensor may not be plugged into the warmer or may be faulty. The audible alarm will sound and the heater will be disabled.

Action: Press the Mute button to silence the audible alarm. The heater will remain disabled until the skin sensor is plugged in or replaced.



See Manual

Disconnect warmer from the power supply, move the baby to another warmer. Contact Biomedical Engineering.



Power Fail

Power to the warmer has been disconnected either because the power supply has been switched off or the warmer has been unplugged.

